

Sheet 2 Fitting Instruction Part No. 503034

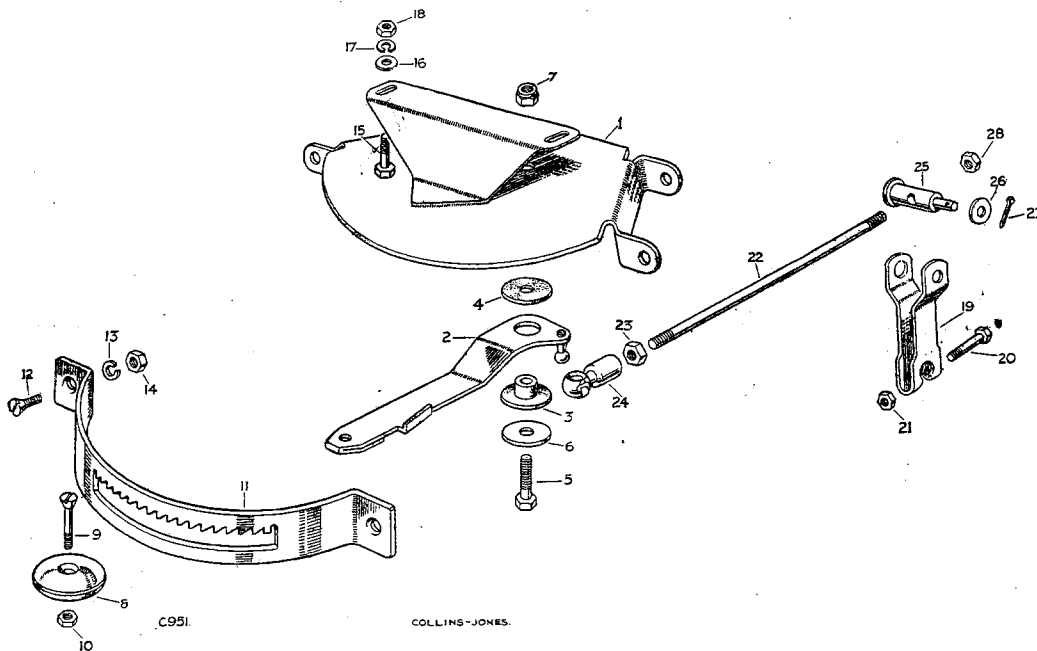

Layout of hand throttle

Note: The numbers in brackets refer to layout drawing above.

PROCEDURE: To assemble quadrant control.

Items 1 to 10 cover all models.

1. Fit lever for hand speed control (2) to lever housing (1) with a large washer (4) above the lever and the bush (3) beneath. Secure with a bolt (5) and plain washer (6) from beneath and a self-locking nut (7) above.
2. Attach the quadrant plate (11) to the front of the housing with its ratchet teeth to the top, and secure it with counter-sunk screws (12), plain washers, spring washers (13) and nuts (14).
3. Fit the knob (8) to the lever with 2 B.A. screws (9) and nut (10).

To fit quadrant assembly to the vehicle.

4. Insert the rubber grommet in the cover panel.
5. Remove the original cover panel from the dash, mounted beneath the instrument panel, and replace with new panel, grommet to the right hand side. Also position the quadrant assembly and fix both with 2 bolts, spring washers and nuts.
6. Screw a 2 B.A. locknut (23) and ball socket (24) on to the control rod (22). Push the control rod through the grommet on the dash and secure the ball joint socket to the ball end on the hand speed control lever.
7. Disconnect the battery feed lead.
8. Remove the 2 B.A. screws holding the instrument panel and pull the panel forward.
9. Fit the two upper bolts (15), plain washers (16), spring washers (17), and nuts (18) securing the control housing to the dash panel.
10. Replace the instrument panel and reconnect the battery lead.